

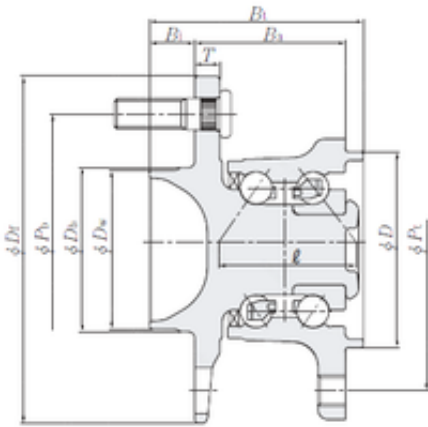

# DDH BEARINGS(UK)LTD.

## NTN HUB231-10 angular contact ball bearings



Bearing No. HUB231-10

Ba	69 mm
Db	68 mm
Df	148 mm
Pb	114,3 mm
Pt	107,004 mm
Bi	15,5 mm
D	84 mm
Dw	66 mm
T	10,5 mm
	70,4 Tolerance h14
Weight	3,08 Kg
Basic dynamic load rating (C)	30,5 kN
Basic static load rating (C0)	23,7 kN
1	Wheel Bearing

HUB231-10 Bearing 2D drawings and 3D CAD models